



# Semiconductor (AC) fuses

## American Round Fuses Form 101 Range A70Q



### Semiconductor Protection Fuses

A70Q Amp-trap® Semiconductor Protection fuses were developed for inverter applications requiring extremely low I<sup>2</sup>t. A70Q fuses provide the most responsive protection for applications not required to sustain heavy overloads.

### Features/Benefits

- Lowest I<sup>2</sup>t of any fuse in this voltage rating for best overall protection
- 700V AC, 650V DC rating allows protection of greater variety of circuits
- Solid fill technology for extra reliability in performance

### Ratings

- AC: 35-600A  
700VAC, 100kA I.R.
- DC: 35-600A  
650VDC, 100kA I.R.  
L/R = 10ms

### Approvals

- UL Recognized Component
- AC: GuideNo.JFHR2
- DC: Tested to UL Standard 198L Parameters (35-600A)

### Highlights

- Extremely Fast Acting
- Current Limiting
- Lowest I<sup>2</sup>t

### Applications

- Protection of inverters and other equipment requiring the best AC or DC protection in this voltage range



### Single Pole Fuse Blocks for A70Q Fuses



Fuse Ampere Rating	Fuse block	
	Catalog Number	Reference Number
35-100	P243C	M219040
125-400	P266A	Y212380
450-600	P266F	S213410

### Catalog Numbering System

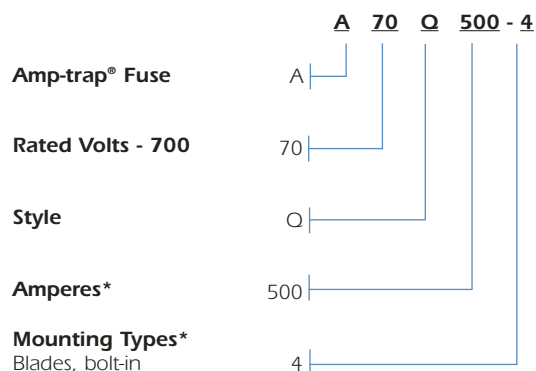

\* For ampere ratings and types not listed, ask sales agent.



## American Round Fuses Form 101 Range A70Q

### Semiconductor Protection Fuses

### Standard Fuse Ampere Ratings

Ampere Rating	Catalog Number	Reference Number
35	A70Q35-4	D214846
40	A70Q40-4	T216884
50	A70Q50-4	N218949
60	A70Q60-4	W219991
70	A70Q70-4	R202714
80	A70Q80-4	K211264
90	A70Q90-4	V211779
100	A70Q100-4	Y218429
125	A70Q125-4	D219469
150	A70Q150-4	H200981
175	A70Q175-4	Y202697
200	A70Q200-4	T211778
250	A70Q250-4	S212812
300	A70Q300-4	V213826
350	A70Q350-4	E215353
400	A70Q400-4	K217405
450	A70Q450-4	S217918
500	A70Q500-4	E219470
600	A70Q600-4	M222674

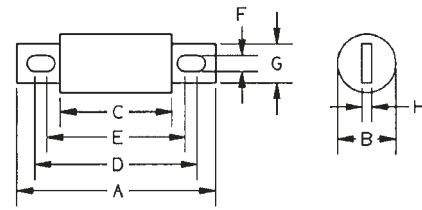

Figure 1

For ampere ratings and styles not listed, call Technical Services.

### Dimensions

Catalog Number	Mounting Type	Dimensions - Inches (mm)							
			A	B	C	D	E	F	G
A70Q35 to 60	4	4.37 (111)	1.22 (31.0)	1.96 (49.8)	3.69 (93.7)	2.91 (73.9)	.34 (8.6)	1.00 (25.4)	.19 (4.8)
A70Q70 to 100	4	4.37 (111)	1.22 (31.0)	1.96 (49.8)	3.69 (93.7)	2.91 (73.9)	.41 (10.4)	1.00 (25.4)	.19 (4.8)
A70Q125 to 200	4	5.09 (129)	1.50 (38.1)	1.96 (49.8)	4.16 (106)	2.91 (73.9)	.41 (10.4)	1.00 (25.4)	.25 (6.4)
A70Q250 to 400	4	5.09 (129)	2.00 (50.8)	1.96 (49.8)	4.00 (102)	2.94 (74.7)	.56 (14.2)	1.50 (38.1)	.25 (6.4)
A70Q450 to 600	4	7.09 (180)	2.50 (63.5)	1.96 (49.8)	5.72 (145)	3.25 (82.6)	.56 (14.2)	2.00 (50.8)	.38 (9.7)