

Other Protistor® Fuses BS88-4 Fuses

Microswitches for BS88-4 Protistor®

MICROSWITCH SYSTEMS ADAPTED
TO THE FOLLOWING FUSES:

- BS88 - 4 separated trip-indicator
- BS88 - 4 built-in trip-indicator

Main Characteristics

| Code | AC Insulation voltage rating (***) | Positive operating voltage/current | Current rating | Current | Interrupting rating | | | | | | AC voltage withstand test (*) | Impulse voltage test Uimp1.2/50 μs (**) | Fire class according to UL 94 |
|-----------------|------------------------------------|------------------------------------|----------------|----------|-----------------------|-------|-------|--------------------------------|-------|------|-------------------------------|---|-------------------------------|
| | | | | | Non inductive circuit | | | Inductive circuit : L/R = 25ms | | | | | |
| | | | | | 30V | 110V | 250V | 30V | 110V | 250V | | | |
| MC 6,3 GR 2-5 N | 1000 V | 20 V 100 mA | 5 A | 50/60 Hz | - | 5 A | 0,3 A | - | 3 A | 2 A | 3.5 kV | - | H.B. |
| | | | | DC | 4 A | 0.4 A | - | 3 A | 0.4 A | - | | | |
| MC 36 GR 2-5 | 1000 V | 20 V 100 mA | 5 A | 50/60 Hz | - | 5 A | 5 A | - | 5 A | 5 A | 7.5 kV | - | |
| | | | | DC | 4 A | 0.4 A | - | 2 A | 0.4 A | - | | | |

* Between power circuit and microswitch terminals as per IEC 60 and 694 (50/60 Hz 1 min duration in dry air)

** Between power circuit and microswitch terminals Uimp: impulse voltage as per IEC 947-1

*** Between power circuit and microswitch terminals

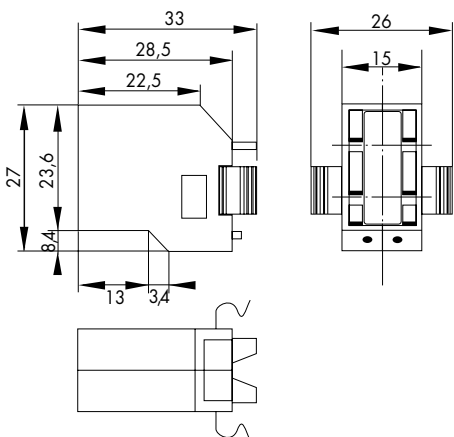
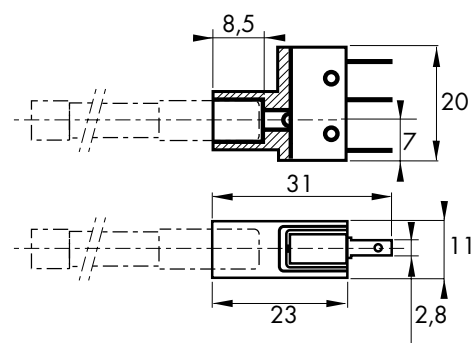

| Catalog Number | Ref. Number | Weight (g) | Pack. |
|--|-------------|------------|-------|
| MC 6,3 GR 2-5 N (for separate trip-indicator) | Y 310015 | 10 | 3 |

| Catalog Number | Ref. Number | Weight (g) | Pack. |
|---|-------------|------------|-------|
| MC 36 GR 2-5 (for built-in trip-indicator) | P 092496 | 10 | 3 |