

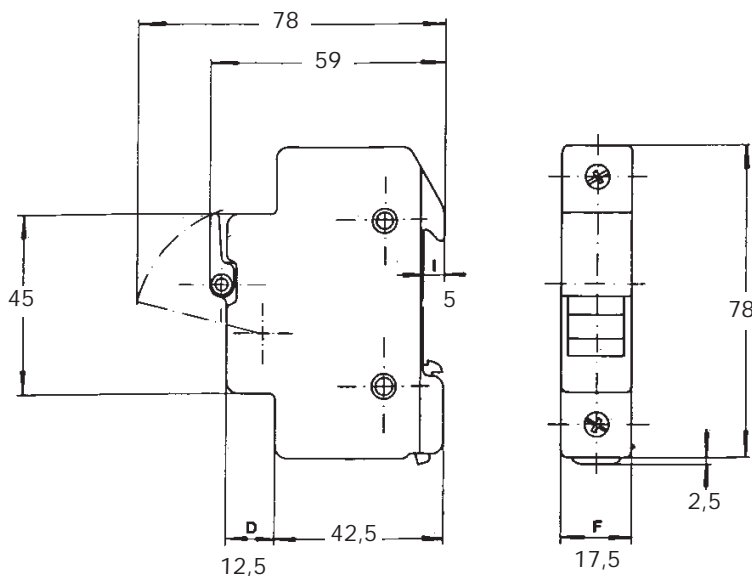

Miniature Fuses Fuse Holders and Disconnectors MSM for 5x20

MSM



- Blown-fuse indicator (120/690V)
- Cable size:
 - Unipolar: 1 x 16 mm²
 - Unipolar + neutral: 1 x 10 mm²
- IP20

MSM

I_n max 16A ; V_n max 250V



J225707

Poles	Size	Previous Ref.	Reference Number	In-Vn	Cat. Number
1	5 x 20	05952	J225707	16A-250V	MIMSM250V16IP
1+N (1 mod.)	5 x 20	05956	K225708	16A-250V	MIMSM250V16IP+N

Assembly pin

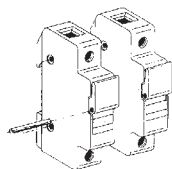

N. Mod.	Previous Ref.	Reference Number	Cat. Number
2	14030	G215125	MSCMSDMAASS2
3	14031	Q216145	MSCMSDMAASS3
4	14032	A217166	MSCMSDMAASS4